

Fusion RECPLEX

Burbank, Illinois

Category: Distinguished Building > \$3Million

Project Data:

Gross Square Feet per floor and total: 37,000 SF

Site Size: 6.8 Acres

Date of Completion: September 2013

Program Statement

The Burbank Park District wanted a community facility with a “fusion” of all ages to meet their indoor recreation needs. With a tight budget and lack of land acquisition funds, the District constructed a new facility in Stevenson Park, between the original 4,000 SF Stevenson Room and Aquatic Center.

The State of Illinois provided \$2.5 million Department of Natural Resources grant funds to help pay for the \$6.5 million project. The resulting “Fusion RECPLEX” 37,000 square foot facility includes a new Gymnasium, Fitness Center, Locker Rooms, Dance/Aerobics, Kids Zone, Running Track, and dividable Program Room. The Entry / Lobby is the “nerve center” of the facility with access to all programs as well as a community gathering place.

The economical use of durable exterior and interior materials as well as sustainable practices makes this facility the focal point of the community. Some sustainable features include minimal storm water impact, a well insulated building envelope, reflective white roof, abundance of glass for views and natural daylight, lighting controls and reuse of the existing park. To that end, “Fusion RECPLEX” is on the verge of becoming LEED certified.

DB3 02-01

Fusion RECPLEX

Burbank, Illinois

DB3 02-02

Category: Distinguished Building > \$3Million

Project Data:

Gross Square Feet per floor and total: 37,000 SF

Site Size: 6.8 Acres

Date of Completion: September 2013

Architect of Record:

Williams Architects

500 Park Blvd. Suite 800 Itasca, IL 60143

(630) 221-1212

ktlellios@williams-architects.com

Architectural Team: Tom LaLonde – Managing Principal, Steve Mihelich – Design Principal, Scott Morlock - Project Architect, Stacy Snapp – LEED Coordinator, Carrie Kotera - Interior Designer

Project Owner:

Burbank Park District

Consultants:

Structural:

KJWW

1100 Warrenville Rd, Ste 400W

(630) 527-2320

penningskr@kjww.com

MEP:

W-T Engineering

2675 Pratum Avenue

(224) 293-6301

steve.triphahn@wtengineering.com

Land Planning/Civil:

Design Perspectives

1754 N. Washington St., Ste 120

(630) 577-9445

tstanton@design-perspectives.net

Interior Design:

Williams Interiors

500 Park Blvd. Ste 800

(630) 221-1212

cakotera@williams-architects.com

Contractors:

Const Manager:

Frederick Quinn Corporation

103 S. Church Street

Addison, IL 60101

(630) 628-8500

jack@fquinncorp.com

Major Sub:

MPZ Masonry

5134 N. Elston Avenue

Chicago, Illinois 60630

(773) 685-0279

mpawlik@mpzmasonry.com

Composite Metal Panels

Omega Lite by Laminators, Inc.

3255 Penn Street

877-663-4277

Sales@laminatorsinc.com

Pre-Cast Concrete Walls

ATMI Pre-Cast

930 Ridgeway Avenue

Aurora, IL 60506

(630) 897-0577

sales@atmiprecast.com

Fusion RECPLEX

Burbank, Illinois

DB3 02-03

Site Plan



Fusion RECPLEX

Burbank, Illinois

DB3 02-04

First Floor

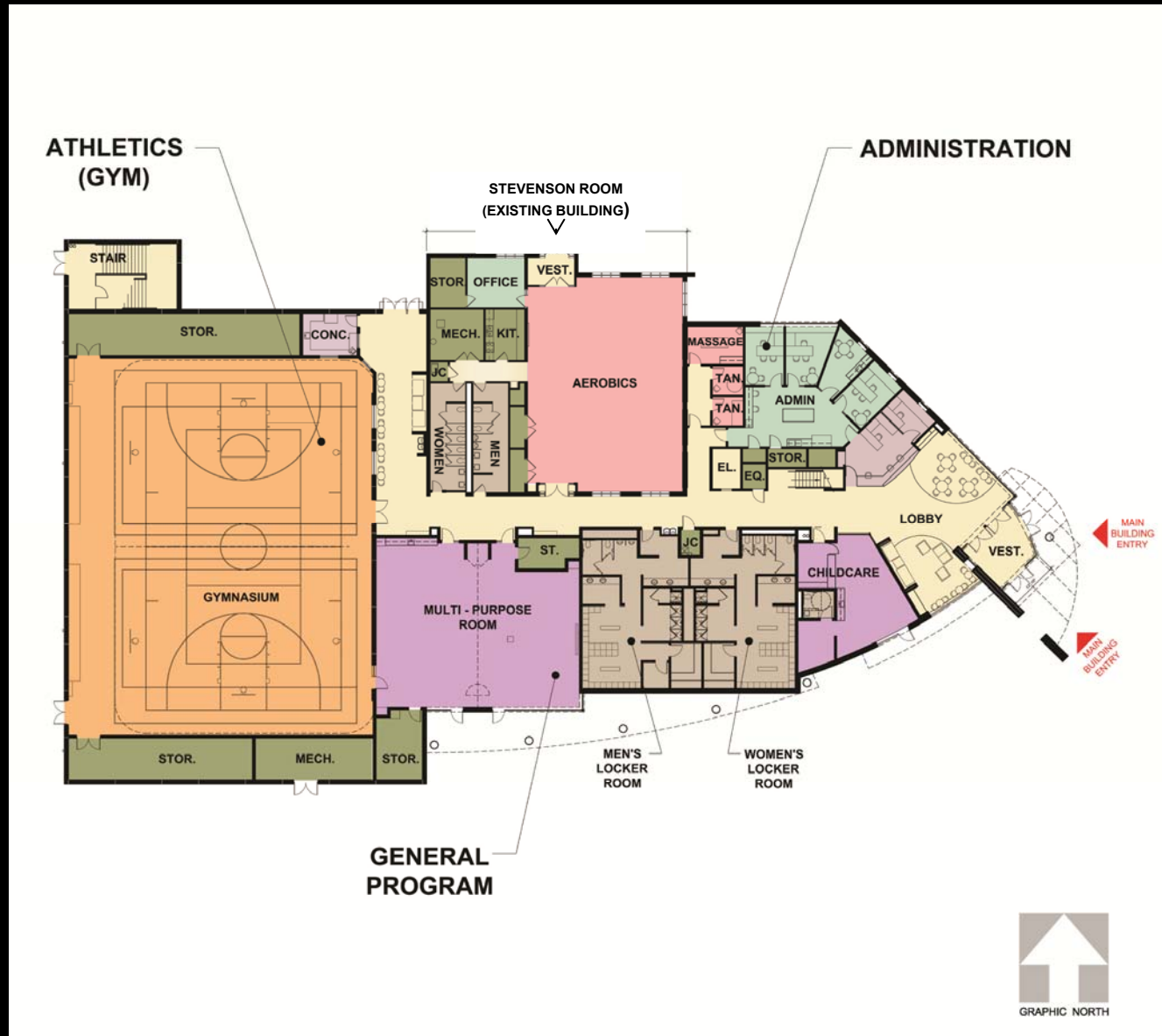

Fusion RECPLEX

Burbank, Illinois

DB3 02-05

Second Floor

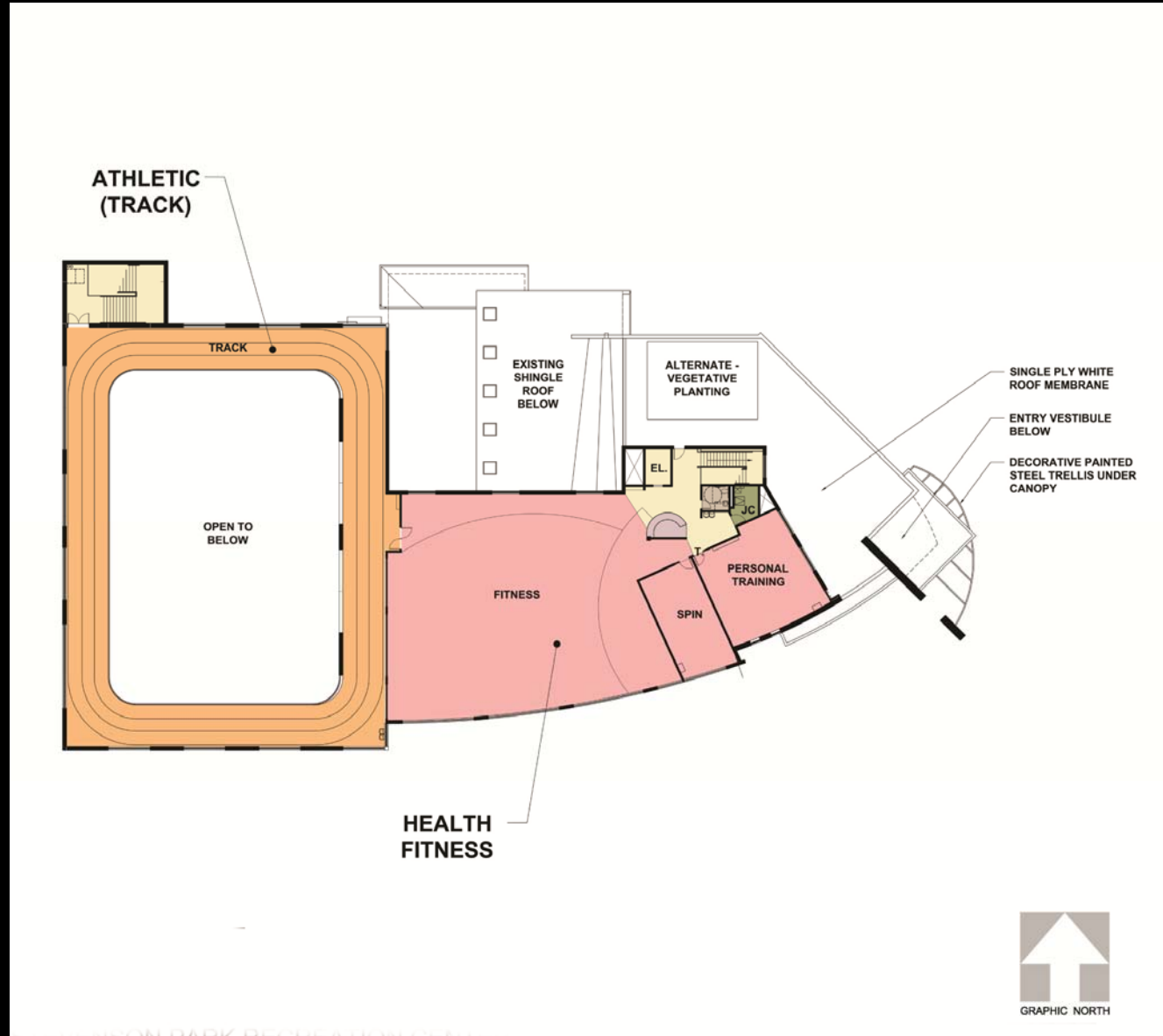

Fusion RECPLEX
Burbank, Illinois

DB3 02-06

Field House
Front Entry Plaza



Fusion RECPLEX

Burbank, Illinois

DB3 02-07

Exterior Views Facing
Aquatic Center



Fusion RECPLEX

Burbank, Illinois

DB3 02-08

Reception / Corridor
Spin / Fitness Area



Fusion RECPLEX
Burbank, Illinois

DB3 02-09

Fitness Area



Fusion RECPLEX
Burbank, Illinois

DB3 02-10

Fitness Control Desk



Fusion RECPLEX

Burbank, Illinois

DB3 02-11

Gym / Running Track /
Fitness Area



Fusion RECPLEX

Burbank, Illinois

DB3 02-12

Entry / Lobby

